

**FRONT ELEVATION**  
R.H. SLIDE DOOR SHOWN - L.H. SLIDE DOOR OPPOSITE

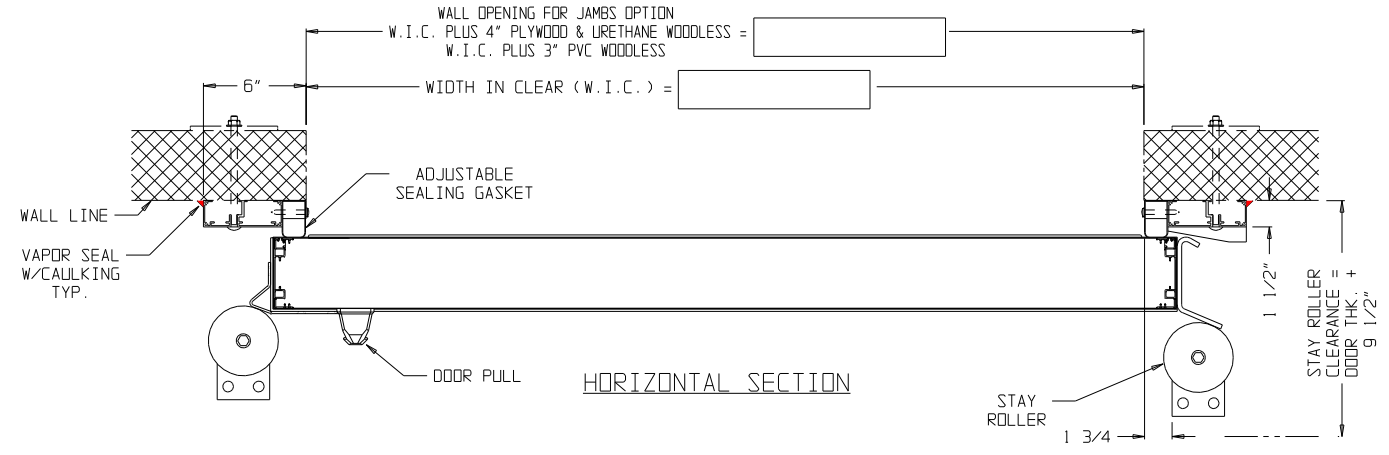

**HORIZONTAL SECTION**

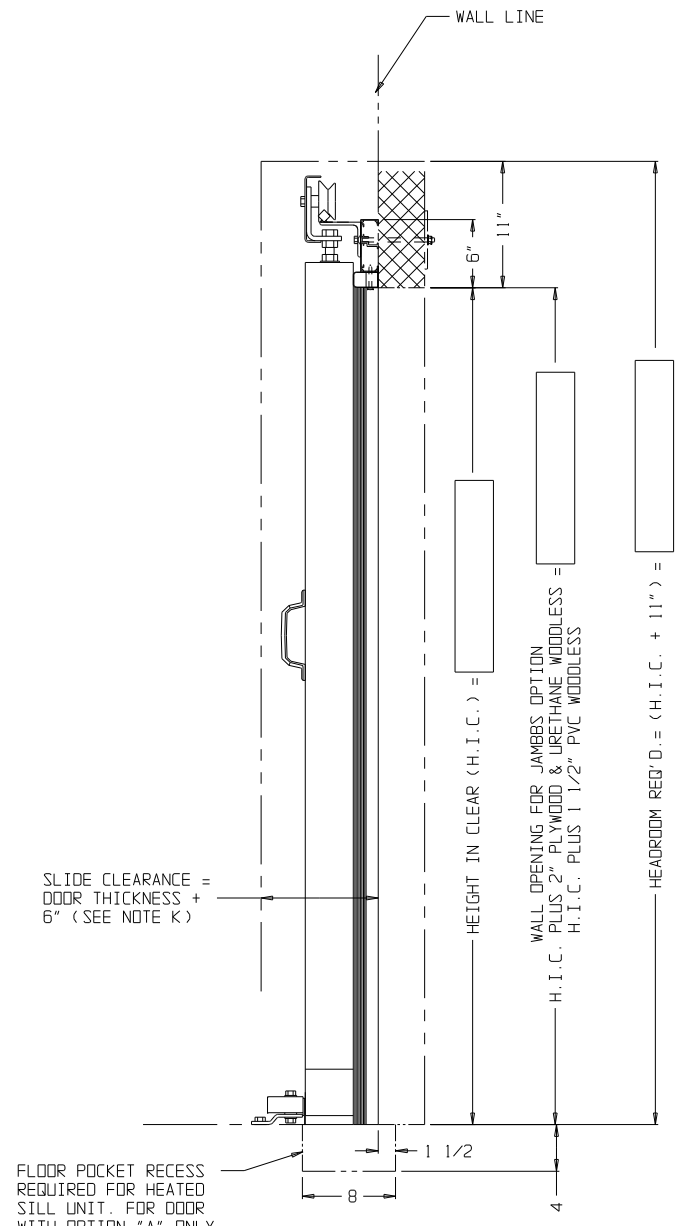

**VERTICAL SECTION**

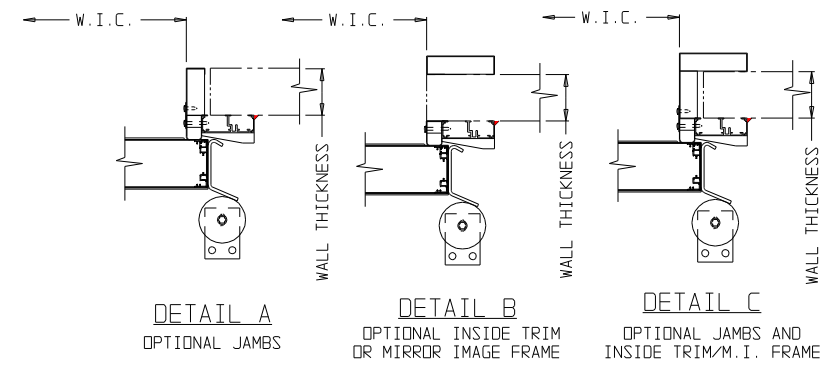

**DETAIL A**  
OPTIONAL JAMBS

**DETAIL B**  
OPTIONAL INSIDE TRIM OR MIRROR IMAGE FRAME

**DETAIL C**  
OPTIONAL JAMBS AND INSIDE TRIM/M.I. FRAME

- NOTES:**
- DOOR PANEL "JAMIFOAM" POLYURETHANE INSULATED.  
R32 @ 20\* F 4" INSULATED  
R48 @ 20\* F 6" INSULATED  
A. COOLER DOOR 4" STD. \_\_\_\_\_   
B. FREEZER DOOR 4" STD. \_\_\_\_\_   
C. FREEZER DOOR 6" STD. \_\_\_\_\_
  - DOOR #26 GAUGE GALVANIZED STUCCO EMBOSSED STEEL WITH BAKED-ON WHITE ENAMEL FINISH. FRAME: ALUMINUM STRUCTURE WITH BAKED-ON WHITE FINISH. \_\_\_\_\_   
OPTIONAL:  
A. GALVANIZED STUCCO EMBOSSED STEEL DOOR W/GRAY FINISH FRAME: ALUMINUM STRUCTURE \_\_\_\_\_   
B. STAINLESS STEEL DOOR WITH STAINLESS STEEL CLAD FRAME \_\_\_\_\_   
C. PAINTED STEEL DOOR AND FRAME - COLOR: \_\_\_\_\_   
D. STUCCO ALUMINUM DOOR WITH GRAY FINISH ALUMINUM FRAME \_\_\_\_\_   
E. WOOD STRUCTURE FRAME - CLAD WITH #24 GAUGE STEEL \_\_\_\_\_   
F. OTHER, SPECIFY \_\_\_\_\_
  - DOOR HARDWARE AND TRACK TO HAVE CORROSION PROTECTIVE FINISH - STANDARD \_\_\_\_\_   
OPTIONAL - CHROME/STAINLESS HARDWARE \_\_\_\_\_
  - FRAME FASTENERS  
3/8" CARRIAGE BOLTS FOR 4" PANEL WALLS, STANDARD. \_\_\_\_\_   
8" LONG STANDARD, 10" LONG WITH MIRROR IMAGE OR INSIDE TRIM.  
OPTIONAL:  
A. 3/8" X 4" LONG LAGS \_\_\_\_\_   
B. 3/8" DIA ALL THREAD THRU ROD \_\_\_\_\_   
C. STAINLESS FINISH (STANDARD WITH STAINLESS FRAMES) \_\_\_\_\_   
D. OTHER (SPECIFY WALL THICKNESS) \_\_\_\_\_
  - INSTALLER TO CONNECT ELECTRICAL POWER TO END OF HEADER ON FREEZER DOORS (120 V.) THROUGH DISCONNECT SWITCHES. SWITCHES AND WIRING NOT BY JAMISON.
  - FREEZER DOORS - FROSTOP AT FOUR SIDES OF DOOR, STANDARD.
  - OPTIONS:  
A. "FROSTOP" - 4 SIDES OF DOOR AND 4 SIDES OF FRAME. \_\_\_\_\_   
B. JAMBS, SPECIFY WALL THICKNESS: \_\_\_\_\_   
C. INSIDE TRIM (1-1/2" X 6" STD.) \_\_\_\_\_   
D. MIRROR IMAGE FRAME \_\_\_\_\_   
E. JAMB & TRIM CONSTRUCTION  
PLYWOOD METAL CLAD \_\_\_\_\_   
WOODLESS URETHANE \_\_\_\_\_   
WOODLESS PVC \_\_\_\_\_   
F. DOOR SEALED TO MEET M.I.D. \_\_\_\_\_   
G. KICKPLATE, DOOR:  
ALUMINUM DIAMOND TREAD, HEIGHT: \_\_\_\_\_   
STAINLESS STEEL, GAUGE: \_\_\_\_\_, HEIGHT: \_\_\_\_\_   
H. KICKPLATE, FRAME -  
ALUMINUM DIAMOND TREAD, HEIGHT: \_\_\_\_\_   
STAINLESS STEEL, GAUGE: \_\_\_\_\_, HEIGHT: \_\_\_\_\_   
I. LEADING EDGE GUARD \_\_\_\_\_   
20 GA. STAINLESS STEEL \_\_\_\_\_ HEIGHT \_\_\_\_\_   
20 GA. GALVANIZED \_\_\_\_\_ HEIGHT \_\_\_\_\_   
\* J. PADLOCKING (SEE SCHEDULE) \_\_\_\_\_   
K. VIEW WINDOWS, SIZE 12" X 14" STD.  
2 LAYER (COOLER) \_\_\_\_\_   
3 LAYER (FREEZER) \_\_\_\_\_   
OPTIONAL HEAT IN ABOVE \_\_\_\_\_   
OTHER \_\_\_\_\_   
+ L. JAMISSTAND SUPPORT SYSTEM \_\_\_\_\_   
DRAWING NUMBER \_\_\_\_\_  
M. WICKET DOOR, - SIZE \_\_\_\_\_   
N. PULL BAR H4475009 \_\_\_\_\_   
O. HIGH HEAT INSULATION \_\_\_\_\_   
P. COIL CORD DROP LOOP \_\_\_\_\_   
Q. HEAVY DUTY STAY ROLLERS \_\_\_\_\_   
R. SHORT HEADER \_\_\_\_\_   
S. LARGE REAR PULL \_\_\_\_\_   
T. OTHER \_\_\_\_\_

+ JAMISSTAND SUPPORT SYSTEMS REQUIRE MORE CLEARANCE THAN SHOWN - SEE DWG. BH-4404106

**CAUTION**  
NOTE-1. DO NOT SCALE DIMENSIONS.  
NOTE-2. DO NOT SCALE BUCKS. BUCK SIZE AND DESIGN BY OTHERS GOVERNED BY DOOR SIZE, WALL CONSTRUCTION AND CEILING HEIGHT.  
NOTE-3. GREATER CLEARANCE MAY BE REQ'D. AT SIDES AND/OR HEAD BY CERTAIN JOB CONDITIONS SUCH AS HIGHER SILL BEVEL OR OBSTRUCTIONS NECESSITATING COCKING OR TILTING FRAME INTO OPENING, ETC.  
NOTE-4. BUCK SUGGESTIONS PER DRAWING BJ-9044-33.

DOOR NO.	QUAN.	SWING		SIZE IN CLEAR		*PADLOCKING PROVISIONS				TEMPERATURE CONDITIONS			
		R.H.	L.H.	W.I.C.	H.I.C.	NO	YES		SAFETY RELEASE		FRONT	BACK	
							FRONT	BACK	YES	NO			

SCALE(S)		JOB NAME			
DATE	DRWN	XXXXXX			
XX/XX/XX	XXX				
CHECKED	APPROVED	TITLE			
JAMISON DOOR COMPANY		MARK IV MANUAL			
P. O. BOX 70		SINGLE DOOR			
HAGERSTOWN, MARYLAND 21741					
				NO. H4404873G	

NO. H4404873G