

MARK IV

InVision®

BI-FOLDING POWER OPERATED COOLER DOOR

digitally controlled fast operating door for high volume traffic

- *PowerTron® Digital Controller*
- *Five Year Limited Warranty (1 year on panels)*

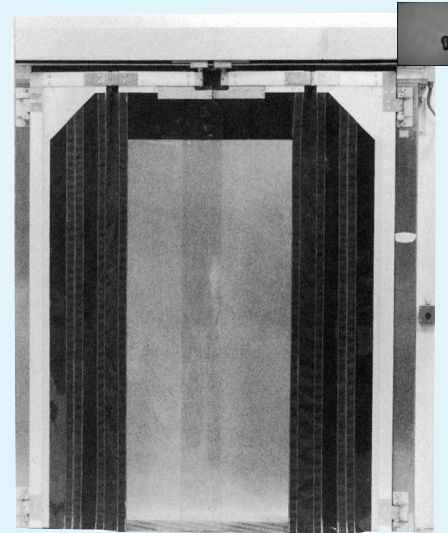

COOLER DOOR SPECIFICATIONS:

Supply where indicated on plans Jamison Mark IV InVision® BiFolding, Power Operated, Cooler Door with PowerTron® Digital Controller.

Door panels to be made of PVC vinyl, supported by anodized aluminum framing and retainers. Center panels to be transparent flexible 0.3" (7mm) thickness and side panels to be orange reinforced vinyl. Panels to be supplied with Velcro® seams.

Casing frame, track angle, header, door panel frame and retainers to be T6063-T6 aircraft grade anodized aluminum alloy. Full width removable hood to be provided with gray painted finish.

Vinyl gaskets to be provided at two sides and across head where door contacts casing frame.

Hardware to have protective coating against corrosion. Heavy-duty side support hinges to have thrust ball bearing and center pivoting hinges to have oil impregnated bronze bearing. Large diameter heavy-duty dual trolley wheels and a #40 drive chain to be furnished.

Door to be equipped with PowerTron Digital Controller, a maintenance free servo drive unit. Door to open at speed up to 100" per second. Control unit includes pre-programmed motor operation, automatic open and close limit setting system and integrated cycle counter. Automatic opening to be provided with two remote control, spring cushioned, low voltage pull cord switches.

Door power to be 120, or 230 volt AC, 60 Hertz, single phase; or 208, 240, or 480 Volt AC, 60 Hertz, three phase. (ARCHITECT TO SPECIFY VOLTAGE.)

Main control panel to be **UL® Listed NEMA 4X enclosure. Lockable disconnect switch to be provided. Control panel to be mounted on door and factory wired to motor. No field wiring required between control panel and motor. (ARCHITECT TO DESIGNATE RESPONSIBILITY FOR FIELD WIRING TO POWER SOURCE.)

NOTE — Door may sweat depending on relative humidity on warm side and temperature differential from front to back of door.

OPTIONS: (Specify which options are desired)

1. Floor Loop Control Box with time delay closing.
2. Motion detector with time delay closing.
3. Electric eye with time delay closing.
4. Electronic radio control operation from lift truck.
5. Metal clad wood jambs, 1-1/2" thick (specify finish of metal).
6. Metal clad inside trim, 1-1/2" x 9-1/2" (specify finish of metal).
7. Cooler door available with 9" or 47" vestibule design, contact factory.

*Velcro is Registered Trademark of Velcro Corporation

**UL is a Registered Trademark of Underwriters Laboratories

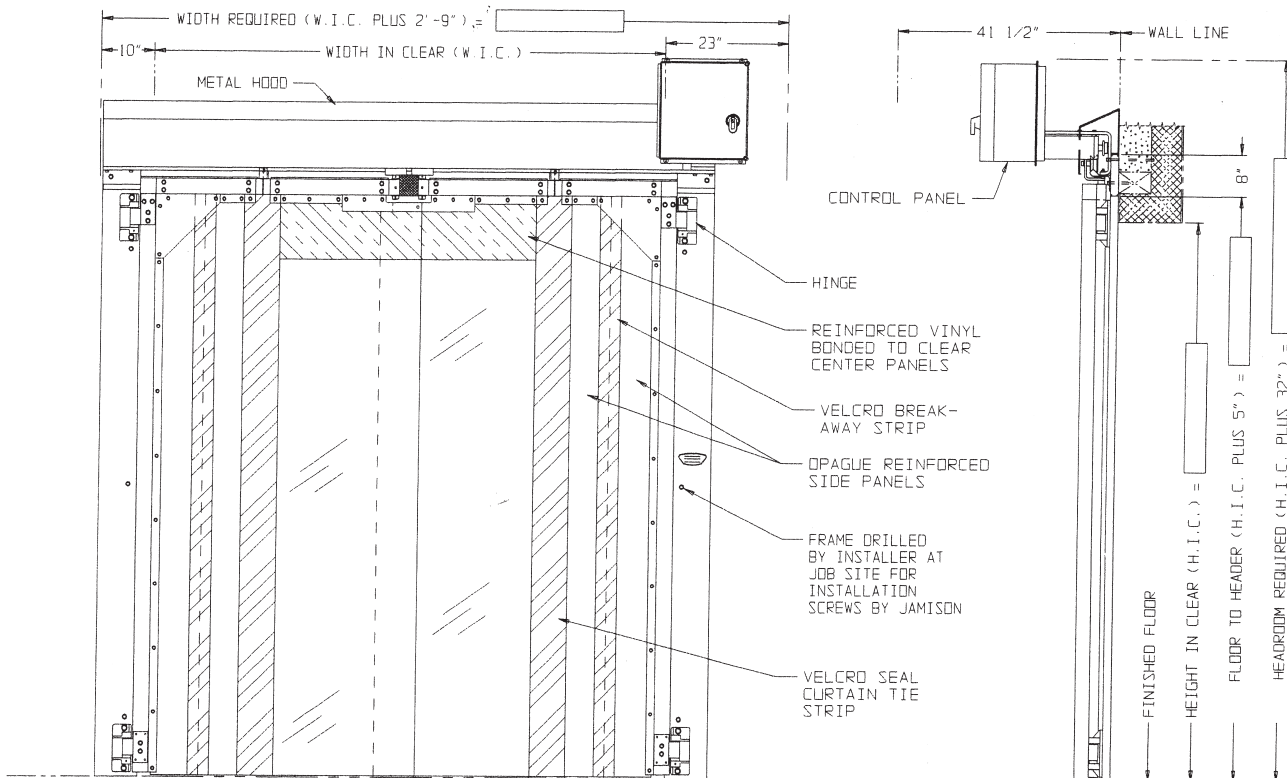

FRONT ELEVATION

SIDE VIEW

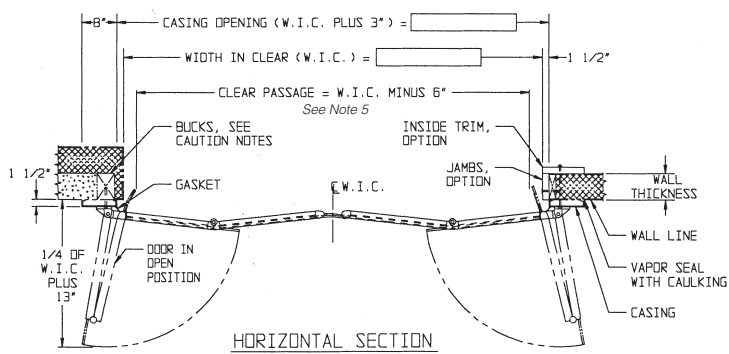

HORIZONTAL SECTION

SIZES AVAILABLE

Standard sizes from 6'0" through 12'0" width in clear x 7'0" through 14'0" height in clear. Special sizes available, contact factory.

CAUTION NOTE:

BUCKS, BUCK DESIGN AND DIMENSIONS AND VAPOR SEALING BY OTHERS.

INSTALLATION POINTS:

1. Bucks should be installed true, plumb and square and of sufficient size to accommodate door weight. Wood bucks should be painted with a suitable preservative to protect against moisture penetration into wood.
2. Unit is factory wired and tested. For shipment, door leaves are disconnected and shipped separately. Field wiring: After erection and mechanical adjustment of door and frame, follow electrical diagram for connection of incoming power to control box.
3. All lags, screws and joints between buck and door frame should be vapor sealed with oil-suspended, nonhardening, waterproof caulking compound or similar material.
4. Drawings for buck suggestions and guard post locations to protect door and frame, available upon request.
5. Clear passage slightly less than the width in clear because the edges of the panels protrude into the opening (maximum 3" each side).



Jamison Door Company • P. O. Box 70 • Hagerstown, MD 21741-0070
 Call Toll Free • 1-800-532-3667 or 301-733-3100
 FAX: 301-791-7339
 INTERNET: <http://www.jamisondoor.com>
 E-MAIL: contact@jamisondoor.com